

ADVANCE INFORMATION

on your participation in the
International General/Admiral Staff Officer Course
in the Federal Republic of Germany



BUNDESWEHR

TABLE OF CONTENTS

EN

1.	Introduction	3
1.1	Points of Contact	4
2.	Your Two Years in Germany	4
2.1	Your Time at the Federal Office of Languages in Hürth	6
2.2	Your Time at the Bundeswehr Command and Staff College in Hamburg	7
3.	Administrative Matters	10
3.1	Participation in the Course	10
3.1.1	Before Coming to Germany (Documents)	10
3.1.2	Personal Preparation/Equipment and Uniform	12
3.1.3	Your Arrival in Germany	12
3.1.4	Accommodation	13
3.1.5	Visas and Residence Permits	13
3.1.6	Health Care	14
3.1.7	Insurance	14
3.1.8	Bank Account and Monetary Transactions	15
3.1.9	Transportation/Driving a Car in Germany	15
3.1.10	Communication/How to Contact You in Germany	16
3.2	Bringing Your Family and Children to Germany	16
3.2.1	Administrative Matters	16
3.2.2	Compulsory Schooling	16
3.2.3	Childcare	17
3.2.4	German Language Training for Your Partner	18
3.2.5	Integration Opportunities for Your Partner	18
4.	What You Can Do to Prepare for the Course	19
5.	Annexes	20
5.1	How to Reach the Federal Office of Languages in Hürth	20
5.2	How to Reach the Bundeswehr Command and Staff College in Hamburg	22
5.3	Plan of the BwCSC's Clausewitz Barracks	24

1. INTRODUCTION

Congratulations!

If you are holding this information in your hands, you have been selected to participate in the International General/Admiral Staff Officer Course (IGASOC) in Germany. We congratulate you on this special assignment!

For more than 60 years, the Bundeswehr has been dedicated to providing initial, advanced and follow-on training to professionally experienced staff officers from Germany and abroad in order to provide the military leaders of tomorrow with the best-possible preparation for their future tasks. More than 600 officers are being trained at the Bundeswehr Command and Staff College (*Führungsakademie der Bundeswehr*) at any given time, among them approximately 100 foreign officers from more than 50 partner nations.

At the end of your training in Hamburg, you and your fellow officers will be comprehensively trained and educated leaders, who have been acquainted with the joint, combined and inter-agency approach to security and are thus well prepared to face future key developments and challenges relying on a broad network of partners.

The training you are going to attend is divided into two phases:

1. During your first year in Germany, you will learn the German language at the Federal Office of Languages (*Bundessprachenamt*) in Hürth. The language skills you will acquire there are a prerequisite for your participation in the IGASOC and the key to a successful performance during the course!
2. You will spend your second year of training at the Bundeswehr Command and Staff College (BwCSC) in Hamburg, where you will be prepared for tasks in higher headquarters and trained in the fields of geopolitics, strategy and operational planning.

Many of the challenges that may arise with your deployment to Germany can be easily met by careful advance preparation in your home country. This document is intended to help you prepare for your stay in Germany.

Let's get to work! We can do it!



1.1 Points of Contact

Your first point of contact is the Armed Forces Office of the German Bundeswehr.

You can contact it through official channels via your national agencies for international cooperation.

If you have any specific questions, please do not hesitate to get in touch with the Federal Office of Languages (FOL):

Your POC at the Federal Office of Languages in Hürth:

2nd Student Company, Federal Office of Languages

E-Mail: BSprABeAMilPersII.Insp@bundeswehr.org

Internet: <https://www.bundeswehr.de/de/organisation/personal/organisation-/das-bundessprachenamt/bundessprachenamt>

We wish you a safe trip to Germany and every success with your course!



2. YOUR TWO YEARS IN GERMANY

Getting to know Germany

Located in the middle of Europe, the Federal Republic of Germany is a free and democratic, social state governed by the rule of law. It consists of 16 federal states.

The country is located in the temperate climatic zone. To the north, it is bordered by the North Sea and the Baltic Sea and to the south by the Alps. With approximately 84 million inhabitants and an area of 357,588 square kilometres, Germany is a densely populated country.

The capital is Berlin. Germany is a member of the European Union, the United Nations, NATO and many other international organisations.

As the biggest economy in Europe, Germany is also one of the largest economies in the world. Germany's cultural treasure trove includes many UNESCO World Heritage sites, cultural monuments and various local traditions and customs you can discover and experience during your time here.

German society is diverse; there is freedom of religion and, as Germany is a secular state, religion is separate from politics.

One of the overarching principles of life in Germany is tolerance vis-à-vis all fellow human beings.

This being said, we encourage you to be open to new things and take inspiration from Germany's great writer Johann Wolfgang von Goethe, who once said that the best education for a clever person is found in travel...

In the first weeks and months in Germany, you will probably come across things that may seem strange to you. Things may work differently here compared to what you have been used to in your home country. In order to gain a better understanding of what to expect, it is therefore important to inform yourself in advance about life in Germany. This document is intended to assist you in this process, as you will have to take the first step of your trip to Germany on your own. Once you have arrived in Germany, there will be service members who can help you with your administrative tasks.

Your stay in Germany will be divided into two phases. You will spend the first year at the FOL in Hürth to acquire the necessary German language skills. Having passed the German language exam, you will move to Hamburg, where you will spend the second year and participate in the IGASOC. In the following chapters, we will give you more detailed information on this topic.



2.1 Your Time at the Federal Office of Languages in Hürth

After your arrival in Germany, you will become part of the 2nd Student Company at the Federal Office of Languages in Hürth, near Cologne. There you will receive qualified assistance in dealing with German authorities.

The FOL is a higher federal authority within the remit of the Federal Ministry of Defence.

As a language service provider, it works to the linguistic needs of the Bundeswehr and also offers language training to other federal ministries. Approximately 15,000 course participants are trained at the FOL each year. Its main responsibility is to provide foreign language training for Bundeswehr members and German language training for foreign military personnel.

In Hürth, you will also meet your three senior MWR officers, one Bundeswehr officer each from the Army, the Air Force and the Navy. They are mainly responsible for planning, preparing and conducting the programme accompanying the training and will support you in all matters related to living in Germany, such as mobile communication, setting up a bank account, insurance or finding accommodation. If necessary, they will also provide advice and support if you are looking for a school or kindergarten place for your child.

Usually, the majority of your fellow students will arrive in August to attend the three-months beginners language course to achieve a Level 1 NATO Standardised Language Profile (SLP) in German. In the second quarter of the training, they will be joined by those who already have basic knowledge of German.



The overall aim of your language training in Hürth is to achieve a Level 3 SLP.

This language profile is a mandatory prerequisite for your participation in the IGASOC. If you fail the exam, you will have to return to your home country.

NATO Standardised Language Profile (SLP):

According to STANAG 6001, the following levels of language proficiency are distinguished:

Level 1: Survival language skills

Level 2: Functional language skills

Level 3: Language skills enabling you to handle most social and professional situations

Level 4: Language skills enabling you to communicate confidently in social and professional situations and to deal even with unfamiliar subject areas

In the first six months of your language training in Hürth, you and your fellow students will be taught in joint classes. In the subsequent six months, you will also receive service-specific language training by three military instructors (one each from the Army, Air Force and Navy). Moreover, you will have to complete an internship in a Bundeswehr unit.

In addition, there will be weekly briefings, excursions and team building measures (sports, hiking, climbing) to strengthen the course community.

You will also be assigned a sponsor, usually a civilian, who will provide advice and assistance and organise further excursions to help you familiarise with the country and its people.

2.2 Your Time at the Bundeswehr Command and Staff College in Hamburg

The Bundeswehr Command and Staff College is the top-level military training institution of the German armed forces.

The IGASOC, a course designed to prepare first-class military leaders, is conducted on a picturesque campus in Hamburg.

The city of Hamburg does not only offer an inspiring environment, but is also a great place for cultural exchange among the participants.

Getting to know the city's rich and diverse history and culture will help you to develop a comprehensive understanding of international affairs.

In the twelve months of the IGASOC, you will be acquainted with a wide variety of topics, ranging from strategic planning and international security issues to diplomatic aspects and brigade-level tactics.

As you and your fellow students already have extensive military experience and come from different armed forces and nations, this course is a great opportunity for you to not only expand your knowledge but also to contribute your perspective and experience in working groups.

In small learning groups you will dedicate yourself to different course contents together with a German mentor. The Course Director is a Bundeswehr colonel (GS).

A key element of the course is the analysis and management of complex military scenarios. In case studies, map exercises and simulations, you will be faced with realistic challenges that require strategic thinking and rapid decision-making.

These theoretical experiences will not only enhance your understanding of various military operations, but also your ability to respond flexibly to evolving situations.



The course also emphasises the importance of peace missions and international cooperation. You will be specifically prepared for the upcoming challenges associated with multinational operations and learn how to effectively cooperate with forces from different countries.

This does not only promote global security, but also strengthens relations between partner states.



Modern approaches to warfare are other important elements of the curriculum. Given the increasing importance of drivers such as digital technologies and constantly evolving cyber threats, you and your fellow students will be given food for thought on how to protect your armed forces in a digital world.

This reflects the reality that modern wars no longer take place on the battlefield only.

Furthermore, particular attention is paid to promoting ethical and professional military standards. In addition to its regular educational activities, the BwCSC offers insightful evening events, lectures on a wide range of topics by high-ranking individuals from the fields of politics, industry, academia, the military and the press as well as study trips to various destinations.

By doing so, it aims to encourage you to integrate a sense of responsibility, integrity and respect for human rights into your leadership practice.

This underlines the importance not only of military effectiveness but also of ethical leadership in modern armed forces. After completion of the IGASOC in Hamburg, you and your fellow students will return to your home countries not only as military experts but also as strategic thinkers and ambassadors for global security.

Your knowledge and skills in the fields of strategic planning, international cooperation and ethical leadership will contribute to promoting peace and stability worldwide.

Moreover, you will greatly benefit from the opportunity of building an international network during your time in Germany – a network that can last a lifetime if you put in your efforts to cultivate and maintain it.



„MENS AGITAT MOLEM“

THE MIND MOVES THE MATTER. This is the motto of the Bundeswehr Command and Staff College.

It reflects the self-image of the Bundeswehr's leading education and training institution.

At the Command and Staff College, command personnel of the armed forces of Germany and its partner nations receive military training and pursue academic studies.



3. ADMINISTRATIVE MATTERS

3.1 Participation in the Course

There are a number of administrative steps you can take even before coming to Germany.

Other administrative procedures can only be started after your arrival in Germany.

If necessary, the MWR staff at the Federal Office of Languages will assist you with these matters. With good preparation, you can speed up bureaucratic processes.



3.1.1 Before Coming to Germany (Documents)

The project directive issued for your training in Germany will be your invitation to participate in the IGASOC and the preliminary language training.

You will receive important advance information about your journey to Germany and organisational prerequisites.

First, please contact your national military attaché through official channels.

You can also obtain further specific information from the German embassy in your home country (please contact the Defence Attaché Office – *Militärattachéstab*).

For your participation in the IGASOC, and if you plan to bring your family with you, you will need a number of documents and also certified translations of these documents into either German or English.

Specifically, we ask you to bring the following:

Passport and identity card Military ID Card	All passports and identity cards for you – and for any family members coming with you – must be valid for the entire stay in Germany.
Certificates	Bring a certified German or English translation of important documents such as university certificates, doctoral certificates, insurance policies, birth and marriage certificates and birth certificates of your children. <u>(Please note that your birth and marriage certificate must be apostilled and translated into German!)</u>
Letter of confirmation (if you will be joined by other family members)	After your arrival and registration in Germany, the MWR staff of the Federal Office of Languages will provide you with a letter of confirmation stating your participation in and the duration of the training measure in Germany. PLEASE NOTE: This is not a guarantee for being issued a visa as that procedure is subject to the provisions governing the issuance of visas as agreed between your home country and the Federal Republic of Germany.
Vaccination record	Bring a record of all your vaccinations and, if you will be accompanied by family members, their vaccination records, too. You will need an English or German version or certified translation of the document(s). We recommend that you get an International Certificate of Vaccination or Prophylaxis (ICVP) as approved by the World Health Organization (WHO) before coming to Germany.
Driving licence	If you want to drive a car or motorcycle in Germany, you will have to bring your valid national driving licence and a valid international driving licence (which actually is a translation of your national driving licence) with you. Both documents must be valid at least until the end of your training in Germany. Only if you provide these documents will the authorities check whether you are entitled to a special permit allowing you to drive a car or motorcycle during your stay in Germany. Please note that not all partner nations have an agreement with Germany over the issuance of such a special permit.
Proof of income	You may be required to provide proof of income, for instance when renting a flat. Please bring a certified German or English translation of the respective documents with you. You may have the option to obtain an income statement via your country's embassy or the responsible defence attaché.
Proof of family health insurance	If you plan to bring your family with you to Germany, you must prove that you have health insurance for all family members in order to obtain the residence permit.
Passport photos	You will need up-to-date biometric passport photos for various ID cards.

3.1.2 Personal Preparation/Equipment and Uniform

For members of the armed forces, an impeccable appearance is an expression of their self-image.

The uniform to be worn within military facilities is the international uniform; specifically, you will need uniforms for classroom instruction and official events as well as a battle dress.

In addition to that, you will need civilian clothing for different occasions (casual, business and sports clothing).



Germany has a temperate climate with warm summers, wet springs and autumns and cold winters.

Do not forget to bring rainwear and warm winter clothing with you. If necessary, you will be issued additional clothing or equipment from the Bundeswehr inventory.



3.1.3 Your Arrival in Germany

Your first point of contact before coming to Germany is your military attaché in Germany.

Your military attaché will coordinate your journey to and arrival in Germany with the 2nd Student Company at the Federal Office of Languages and the International Cooperation Section of the Armed Forces Office.

If specified in the bilateral agreement between your home country and the Federal Republic of Germany, the MWR staff at the FOL will provide a pick-up service from Düsseldorf or Cologne Bonn Airport and support you upon your arrival.

If you make your own travel arrangements, please take care to book a flight that is scheduled to arrive NO LATER THAN 8 p.m. local time ON A WEEKDAY (Monday to Friday). Otherwise the MWR staff at the FOL will not be able to pick you up from the airport.

3.1.4 Accommodation

As a rule, service members are accommodated in the military facilities where their training takes place; they are usually assigned single rooms.

However, the Bundeswehr does not allow families to be accommodated on military premises.

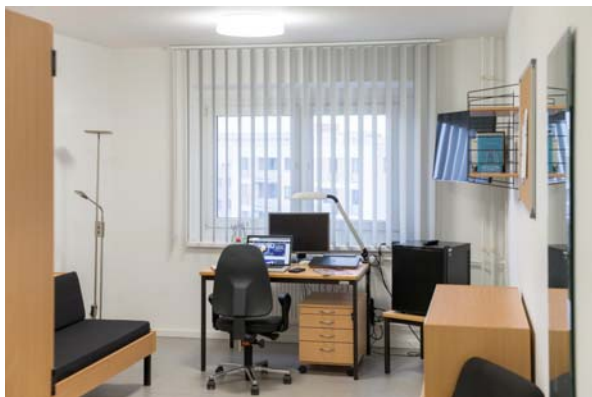

If you plan to bring your family with you to Germany, you will have to rent an apartment on the civilian market on the terms and conditions customary in Germany.

Please consider that rents in Germany are relatively high.

Both the FOL and the BwCSC have a limited number of flats at a slightly lower rent available in Hürth and Hamburg. Subject to availability, you may apply for one of these flats once you have arrived in Germany.

Moreover, the MWR staff in Hürth will assist you in finding a suitable flat and in the administrative procedures with the landlords after your arrival in Germany.

3.1.5 Visas and Residence Permits

In Germany, the military does not enjoy any privileges vis-à-vis the rest of society.

Thus, it is not possible to assert influence on the authorities to obtain visas for family members. Therefore, we urgently advise you to comply with the deadlines and procedures specified by your embassy.

You can start your preparations while still at home: Contact the German embassy in your home country or go to the website of Germany's Federal Foreign Office to find out how to apply for visas for your family members.

Please note: there is a difference between the visitor visa (Schengen visa) and the visa for family reunification. Your family must apply for the correct visa at the German embassy in your home country. A visitor visa is only valid for up to 3 months, a visa for family reunification is valid for the entire period of stay or the duration of the course.

Assemble the relevant documents. In order to obtain a residence permit in Germany for the entire duration of the IGASOC project, you must register with the public authority responsible for foreign nationals (*Ausländerbehörde*) after your arrival in Germany.

The MWR staff in Hürth will assist you in registering in Germany and applying for your residence permit.

If you plan to take your family to Hamburg in the second year, you must first register your family with the Office for Migration in Hamburg (please note that the German embassy in your home country will send the documents for the family visa procedure to the Office for Migration in Hamburg and not to Hürth!).

The MWR staff will answer all your questions regarding your family's move to Hamburg after your arrival in Germany.

3.1.6 Health Care

As a matter of principle, your health care needs will be met by doctors and dentists of the Bundeswehr Medical Service.

This applies to general health and illness issues ONLY during duty hours (Monday to Friday) and to outpatient medical treatment by civilian specialists ONLY upon referral from the unit physician.

Health care provided by the Bundeswehr Medical Service is generally free of charge for you. Outside duty hours and when traveling to other countries within or outside the EU, no health care services will be provided by the Bundeswehr.

However, the costs for medical measures provided by civilian service providers (emergency services, doctor's offices, hospitals, etc.) are not borne by the Bundeswehr. Further details can be found in your project decree.

PLEASE NOTE: There may be occasions, such as emergencies in Germany or during private trips, when you might need a civilian ambulance, have to see a medical specialist or go to a civilian hospital.

These emergencies as well as external laboratory costs are not covered by Bundeswehr medical care.

Since very high costs may arise very quickly in case of a medical emergency, we advise you to inform yourself about adequate international health insurance before coming to Germany. Numerous international insurance companies offer health insurance and supplementary insurances for foreigners in the Federal Republic of Germany.

Take out health insurance for your time in Germany in order to be protected in an emergency and to avoid high costs in case of illness.

If you plan to bring your family with you to Germany, you must prove that you have health insurance for all family members in order to obtain the residence permit.

3.1.7 Insurance

Please enquire with your superior agencies whether you will have insurance via your armed forces for the duration of your stay in Germany.

The Bundeswehr is not allowed to recommend any specific insurance companies.

There are numerous (also international) insurance providers for all types of insurance and we recommend that you look for information online before coming to Germany. There are many different types of insurance serving different purposes.

You should consider taking out the following essential insurances for your time in Germany:

Health insurance: See previous section 'Health Care'.

Motor vehicle insurance (third-party liability insurance): If you wish to purchase and drive a car in Germany, you must take out motor vehicle insurance (third-party liability insurance).

Personal liability insurance and (tenant) legal protection insurance: Both a personal liability insurance and a legal protection insurance may be useful if you (and your family) wish to be protected against claims for damage caused by yourself or in legal matters (for example in disputes arising from your rental contract).

Home contents insurance: A home contents insurance may be useful if you want to rent a flat and have all your home contents insured, including furniture, clothing or electronic equipment.

3.1.8 Bank Account and Monetary Transactions

A bank account will be vital for you to participate fully in everyday life.

If you want to live in Germany for a longer period of time, you will need a German bank account (current account), for example to rent a flat. However, there is no legal obligation to have a bank account in Germany.

If you have an account with an international bank, you may be able to continue using that account. This depends on whether your bank also operates in Germany.

If your family wants to join you here in Germany, a bank account becomes particularly important, for instance as you will be required to make payments for childcare. You will also need a bank account to pay insurance premiums (for instance for your car insurance) or to transfer the rent for your flat.

In order to open a bank account, one usually needs the following:

- a fully filled out application form (available at the bank),
- a valid passport, a current residence permit or visa valid for your stay in Germany,
- proof of residence (*Meldebescheinigung*),
- a first deposit.

In most shops in Germany, the preferred means of payment are cash, EC card (also referred to as Girocard) or credit card. Smaller grocery stores, stalls at weekly markets or bakeries often only accept cash; others accept card payments only from a minimum purchase value.

For purchases on the internet, you may pay by credit card, SOFORT direct bank transfer, GiroPay or PayPal, depending on the company's preferences.

Please note that banks may charge service fees, for example monthly charges for the management of your account or for money transfers to non-European countries. It is therefore worthwhile to compare different banks before opening your current account.

In Germany, you will find various types of banks including private banks, savings banks, cooperative banks, international banks and app-based banks.

Please note that some of these banks operate only regionally and are therefore not a suitable option for you.



Since we cannot provide all details on banking matters in this brochure, the MWR staff will be happy to answer your questions or assist you in choosing a bank when you are in Germany.

3.1.9 Transportation / Driving a Car in Germany

Germany has a well-developed road and rail network. With the *Deutschlandticket* (currently EUR 49 per month), you can travel throughout Germany using local and regional public transport.

In order to drive a rental car or your own vehicle in Germany, you will need a valid national driving licence and a valid international driving licence (or a certified translation of your national driving licence).

They entitle you to drive a car for a maximum of six months.

Foreigners staying longer than six months have to apply for a special permit at the competent authority.

After your arrival, the MWR staff will assist you in applying for this special permit for the period of your stay in Germany.

3.1.10 Communication / How to Contact You in Germany

At the Bundeswehr facilities in Hürth and Hamburg, free WiFi will be provided for you, giving you the opportunity to use your private IT equipment to communicate with your family at home via internet telephony or e-mail.

There are several mobile service providers in Germany offering mobile phone plans and contracts.

However, there are only three main mobile network operators, i.e. three companies operating the network infrastructure.

These are Telekom, Telefónica and Vodafone.

Most mobile service providers offer a variety of plans and contracts to serve their customers' different needs.

Their tariffs cover a wide spectrum of services such as data contingents and flat rates. In order to find the best mobile tariff for you, we thus advise you to compare the available options.

3.2 Bringing Your Family and Children to Germany

Before bringing your family to Germany, we recommend that you first assess the progress you are making in learning the German language at the FOL.

3.2.1 Administrative Matters

Failure to pass an interim examination may result in a termination of the project and your return to your home country.

Therefore, we advise you to take a few months to see how you get along in your language training and then plan your family's move to Germany.

After your arrival, the senior MWR officers and the personnel of the 2nd Student Company at the FOL will be happy to assist you with all administrative matters regarding your family's move to Germany.

This includes for instance support in the visa process, the search for a suitable flat or the search for childcare spots and schools.

3.2.2 Compulsory Schooling

All children living in Germany must go to school.

Compulsory school attendance usually starts in the au-

turn of the year in which a child becomes six years old and lasts until the end of the school year in which they turn 18.

As education is regulated by the federal states in Germany, the specific regulations governing compulsory schooling vary from state to state.

Children may be enrolled at any time during the school year.

Although public schools are generally free of charge, parents usually have to pay for after-school care and school meals.

In addition, there are private schools in Germany, which usually charge tuition fees.

In Germany, school education is subject to regulation by the federal states, which is why educational programmes and particularly the names of the secondary school types differ from state to state.

Generally, the German school system comprises the following school types:

- primary school

(*Grundschule*, mostly Years 1 to 4)

- lower secondary school

(*Hauptschule*, up to Year 9 or 10)

- intermediate secondary school

(*Realschule*, up to Year 10)

- academic secondary school

(*Gymnasium*, up to Year 12 or 13)

- comprehensive school

(*Gesamtschule* combining different types of schools)

What type of secondary school a child attends depends on their performance in primary school.

In the first years, however, all children learn together in primary school. In this respect, the principle of residence applies, meaning that children usually attend a primary school near their place of residence.

A first overview of the German school system, school types and school-leaving qualifications can be found in several languages on the following website: <https://www.deutschland.de/de/topic/wissen/das-schulsystem-in-deutschland-im-ueberblick>.

The schools in Hürth and Hamburg have a lot of experience with children whose mother tongue is not German and they have been working together with the Bundeswehr for many years.

After your arrival in Germany, the senior MWR officers at the FOL will assist you with all questions regarding the selection of a school that best suits your child and that offers special German language classes.

3.2.3 Childcare

In Germany, young children receive age-appropriate care and individual support in their development by pedagogically trained specialists in a kindergarten or day-care centre (*Kindertagesstätte*).

The places where such care is provided may have different names depending on the region. The German *Kindertagesstätte*, usually abbreviated as *KiTa*, often serves as a collective term for different types of childcare.

Specifically, a distinction is made between the following:

- A **Kindergarten** caters for children aged 3 to 7 and prepares them for primary school. The children usually spend the morning in the kindergarten; some also have lunch there and stay until the afternoon.
- **KiTa** – A day-care centre offers all-day care for children between the ages of 2 1/2 and 7 years. Depending on the federal state or region, day-care centres may include a nursery (for children aged 0 to 2) and/or after-school care (lunch and homework support for pupils in Years 1 to 6).
- Day care provided by a **childminder** – In this form of childcare, a male or female childminder (in German usually referred to as a *Tagesvater* or *Tagesmutter*) looks after a small group of children, usually in his/her own home.

A childminder is an attractive and flexible option, especially for families with children under three years of age, as they provide family-oriented and individual care and also help parents to combine family and work responsibilities.

- There is a KiTa on the grounds of the Bundeswehr Command and Staff College – the *Evangelische Kindertagesstätte Blankenese im Bereich der Führungsakademie*, which provides day care for children aged 11 months to 6 years. If you are interested in a place for your child in this KiTa, please contact the MWR staff at the Federal Office of Languages.

Legal entitlement to childcare:

In Germany, all children from the age of one are legally entitled to attend a childcare facility. In order to find a place for your child in a childcare facility, you can use one of the online portals run by the federal states.

How to find the right childcare option

- **Step 1: Search:** Start your search online on the websites of the respective local authorities (for example on the website of the city of Hürth). The competent youth welfare office will provide you with information on all aspects of child day-care.
- **Step 2: Choose:** We recommend that you visit the childcare facility you are interested in and arrange a meeting with the management.
- **Step 3: Register:** As soon as you have found a suitable childcare centre, you can register your child at that facility and conclude a contract. Childcare costs vary. Please contact the respective day-care facility for more information. Many facilities have registration deadlines and waiting lists. Therefore, it is advisable to contact several day-care facilities as early as possible.

The MWR staff at the FOL will assist you in providing the latest information and in finding a suitable day-care place for your child or in registering with a day-care facility.

3.2.4 German Language Training for Your Partner

German language classes for partners of IGASOC students are offered both at the FOL in Hürth and at the BwCSC in Hamburg.

In addition, there are opportunities to practice the language not only with your sponsors in the scope of the sponsorship programme but also with other Germans and their families from all parts of society.

They will help you and your family to get accustomed to life in Germany and to learn the language; by organising excursions and attending events together with you, they will support you in getting to know the country.

3.2.5 Integration Opportunities for Your Partner

There will be numerous events at both the Federal Office of Languages in Hürth and the Bundeswehr Command and Staff College in Hamburg that involve the students' families and provide networking opportunities for them.

The sponsorship programme offers interesting opportunities to explore Germany's culture and society outside the classroom, to exchange ideas and to develop lifelong friendships.

Please do not hesitate to contact us if your partner is interested in qualification measures such as job shadowing, internships etc. in Germany.

If possible, we will be happy to assist you in integrating your partner into a specific work environment.



4. WHAT YOU CAN DO TO PREPARE FOR THE COURSE

What else should you bring with you?

Even though the administrative preparation for the course is important, you – being a senior officer and representative of your home country – are also expected to be able to provide expert information about your country.

Particularly during your time in Hamburg, you will not only be frequently asked to share your country's perspective on matters discussed in class but also to give brief presentations on your region (open sources, non-military classified information) .

During the course, you will mainly work with Microsoft Word and prepare your presentations using Microsoft PowerPoint.

Consequently, we expect you to be proficient in using these software programmes.

These are some of the topics you should be familiar with:

1. National strategies
2. National doctrine (operational and tactical)
3. National structures:
 - political system
 - organisation of the state
 - political parties and electoral procedures
4. Armed forces and services:
 - mission and organisation
 - strength/budget/equipment
 - operational doctrine
 - decision-making process and staff work
5. Regional security environment
6. National economy and industry
7. Social aspects and discourses in society
8. National history, traditions and culture

5. ANNEXES

5.1 How to Reach the Federal Office of Languages in Hürth

Anfahrtskizze Bundessprachenamt Hürth

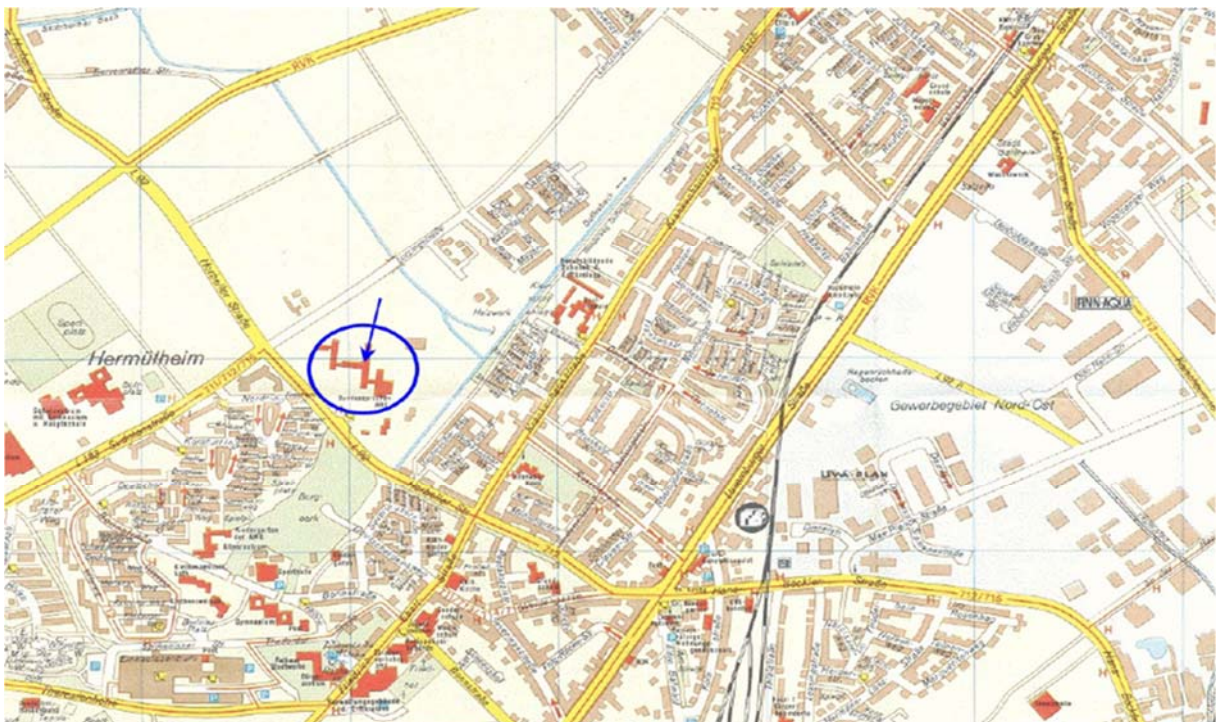
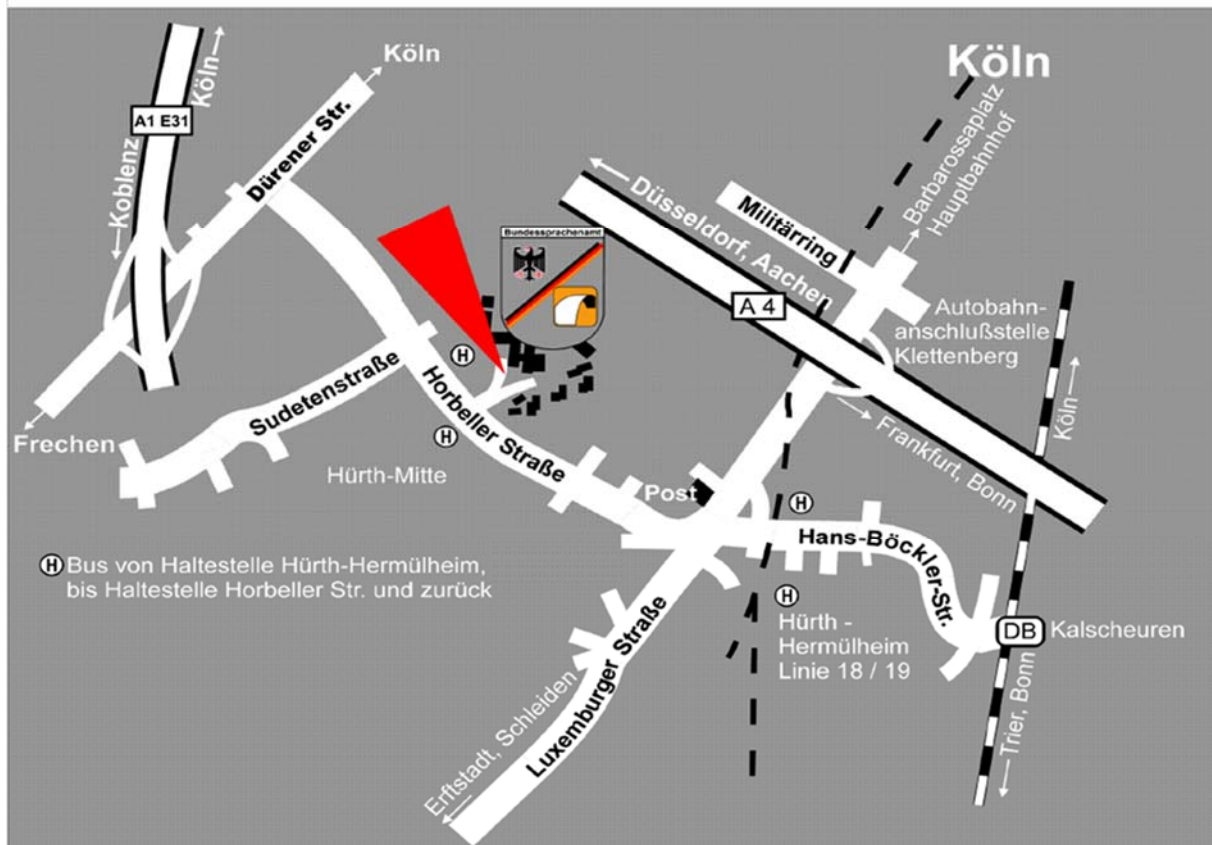

Anfahrtskizze Bundessprachenamt Hürth	Access routes
H Bus von Haltestelle Hürth- Hermülheim, bis Haltestelle Horbeller Str. und zurück	You may take the bus from <i>Hürth- Hermülheim</i> to <i>Horbeller Straße</i> and back
H	Bus stop
Post	Post office
Hauptbahnhof	Main station
Linie 18/19	Bus route 18/19
Autobahnanschlussstelle Klettenberg	<i>Klettenberg</i> motorway junction

5.2 How to Reach the Bundeswehr Command and Staff College in Hamburg

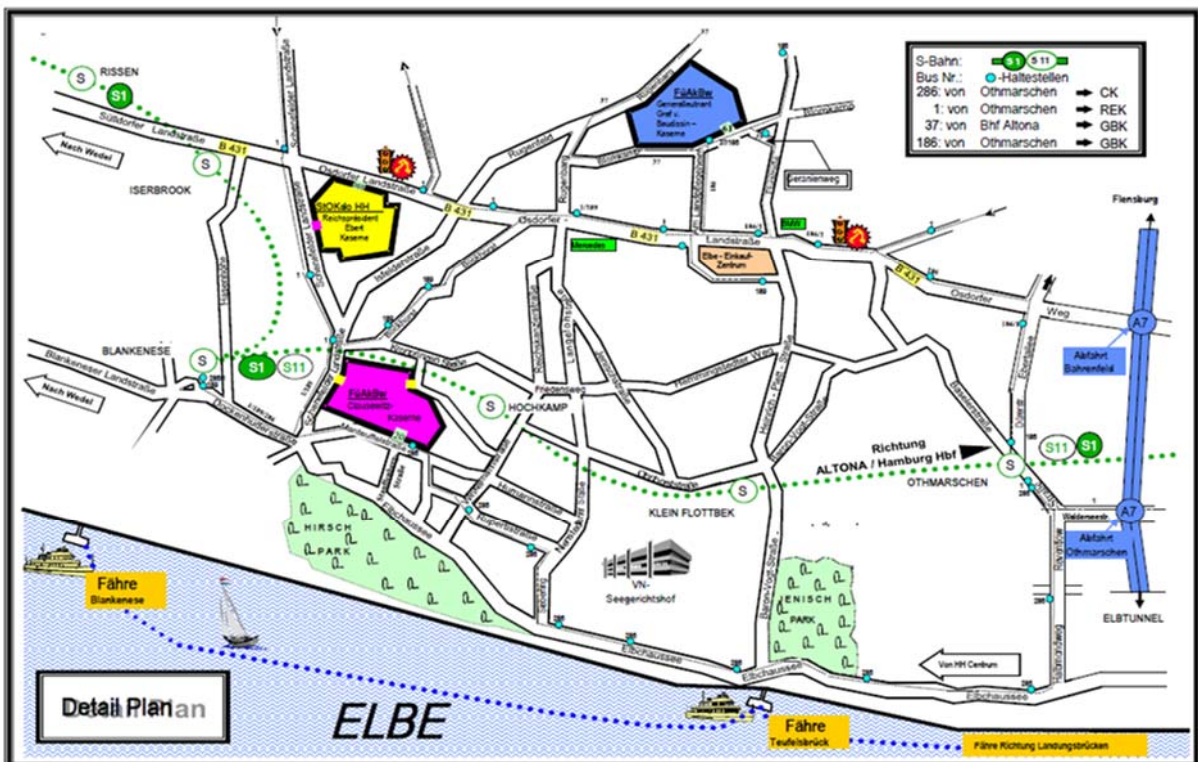
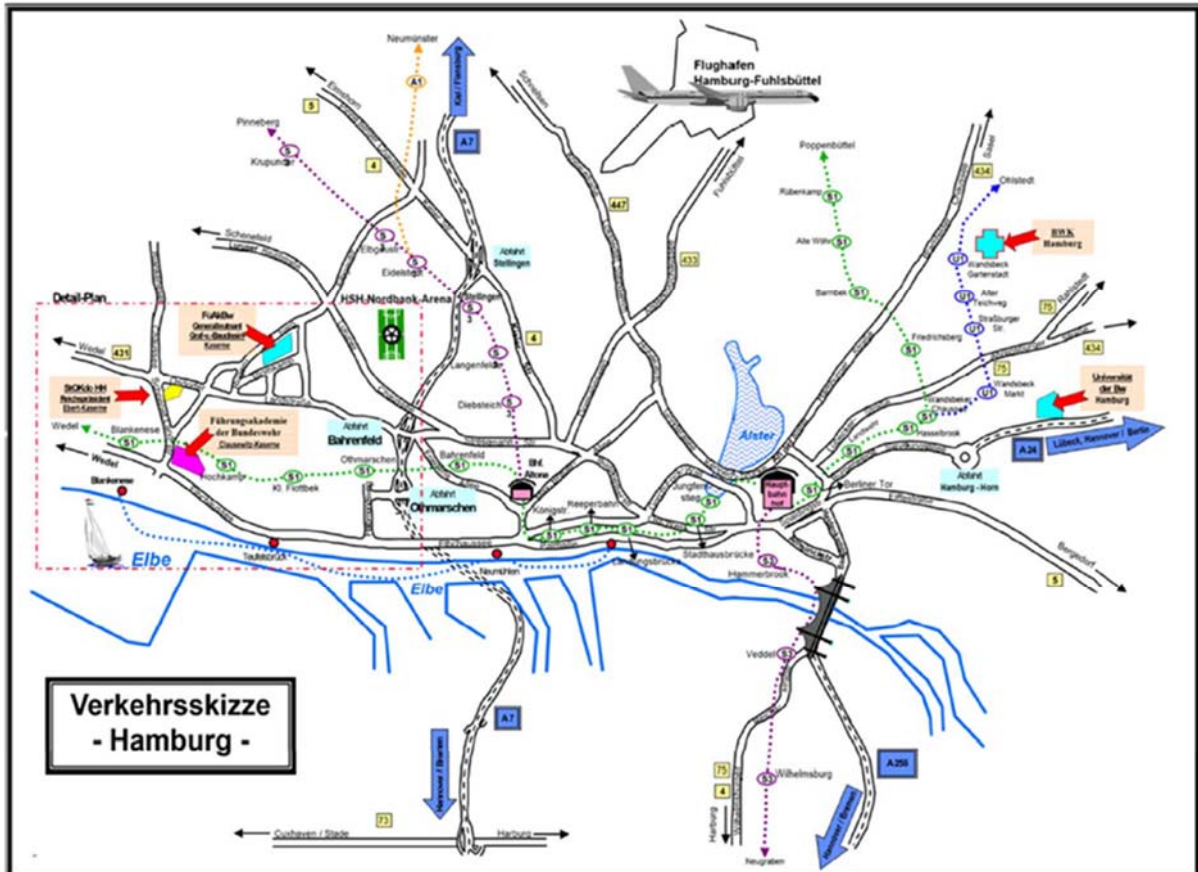

Verkehrsskizze Hamburg	Hamburg street and public transport map (simplified)
Flughafen Hamburg-Fuhlsbüttel	Hamburg-Fuhlsbüttel Airport
Detail Plan	Detailed map

5.3 Plan of the BwCSC's Clausewitz Barracks

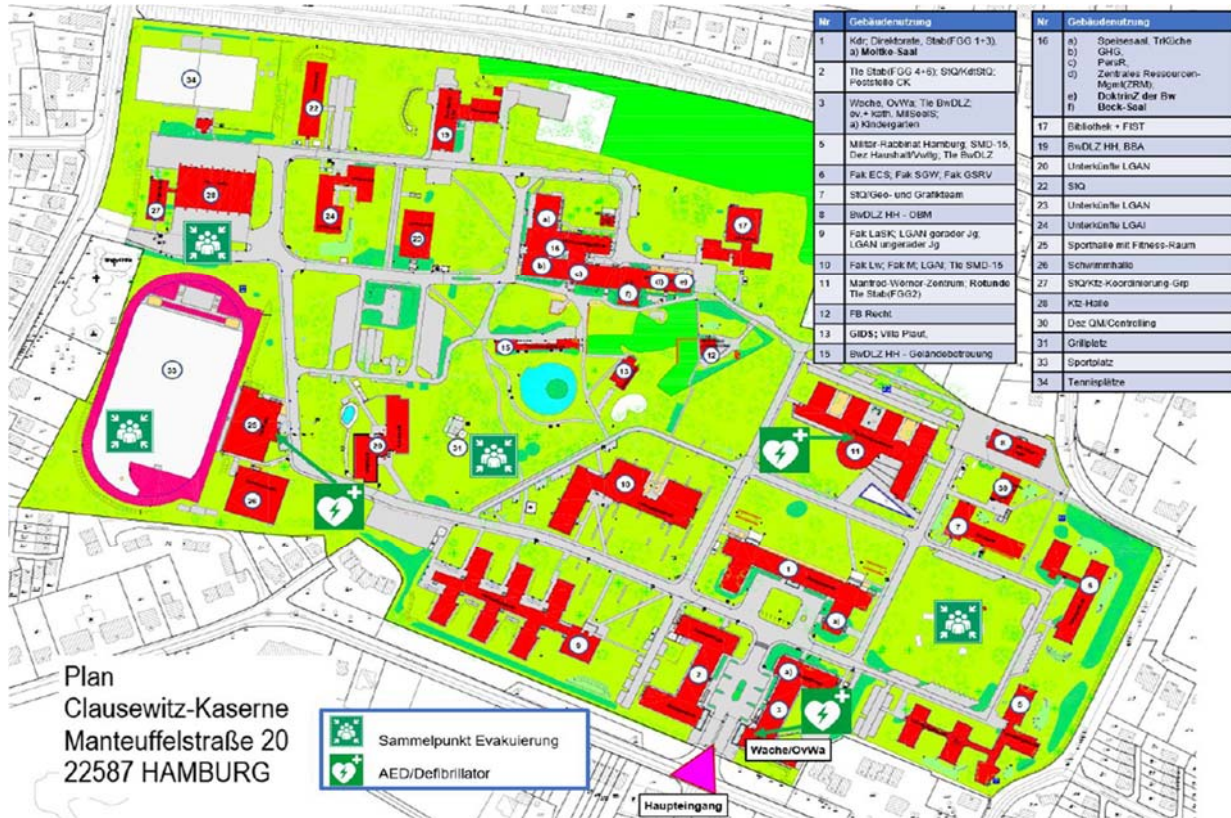

Plan Clausewitz-Kaserne	Plan of the Clausewitz Barracks
Sammelpunkt Evakuierung	Evacuation assembly point
AED/Defibrillator	AED/defibrillator
Haupteingang	Main gate
Wache/OvWa	Guard/Cdr of the Guard
Nr	No.
Gebäudenutzung	Use of building/area
Kdr; Directorate, Stab (FGG 1+3), a) Moltke-Saal	Commandant; directorates, HQ (S1 and S3); a) Moltke Hall
Tle Stab (FGG 4+6); StQ/KdtStQ; Poststelle CK	HQ elements (S4 and S6); Support Unit/Head of SU; mail room
Wache, OvWa; Tle BwDLZ; ev.+ kath. MilSeels; a) Kindergarten	Guard & Cdr of the Guard; elements of Bundeswehr Service Centre (BwDLZ); Military Chaplain Service (protestant and catholic); a) Kindergarten

Militär-Rabbinat Hamburg; SMD 15; Dez Haushalt/Vwltg; Tle BwDLZ	Military Rabbinate Hamburg; Language Services Branch SMD 15; Budget and Administration Branch; elements of Bw Service Centre
Fak ECS; Fak SGW; Fak GSRV	Faculty of Joint Operations/Cyber and Information Domain Service/Joint Support and Enabling Service (JCJ Fac); Faculty of the Medical Service and Health Sciences (MedS&HS Fac); Faculty of Comprehensive Defence and National Resilience (CD&NR Fac)
StQ/Geo- und Grafikteam	SU elements/GeoInfo Centre, graphic design team
BwDLZ HH-OBM	Bw Service Centre Hamburg – facility management
Fak LaSK; LGAN gerader Jg; LGAN ungerader Jg	Faculty of Land Forces (LF Fac); NGASOC (even years), NGASOC (odd years)
Fak Lw; Fak M; LGAI. Tle SMD-15	Faculty of Air Forces (AF Fac); Faculty of Naval Forces (NF Fac); IGASOC; elements of Language Services Branch SMD 15
Manfred-Wörner-Zentrum; Rotunde Tle Stab (FGG2)	Manfred Wörner Centre w/rotunda; HQ elements (S2)
FB Recht	Legal Affairs Division
GIDS; Villa Plaut	GIDS; Villa Plaut
BwDLZ HH - Geländebetreuung	Bw Service Centre Hamburg – roads and grounds maintenance
Speisesaal, TrKüche	Dining facility, dining hall
GHG	All Ranks Club (GHG)
PersR	Staff council
Zentrales Ressourcen- Mgmt(ZRM)	Central Resources Management (ZRM)
DoktrinZ der Bw	Bw Doctrine Centre
Beck-Saal	Beck Hall
Bibliothek + FIST	Library/Expert Information Centre
BwDLZ HH, BBA	Bw Service Centre Hamburg; Federal Building Department

Unterkünfte LGAN	Accommodation (NGASOC students)
StQ	SU element
Unterkünfte LGAN	Accommodation (NGASOC students)
Unterkünfte LGAI	Accommodation (IGASOC students)
Sporthalle mit Fitness-Raum	Sports hall with fitness room
Schwimmhalle	Indoor swimming pool
StQ/Kfz-Koordinierung-Grp	SU element/motor vehicle coordination group
Kfz-Halle	Vehicle depot
Dez QM/Controlling	Quality Management and Controlling Branch
Grillplatz	Barbecue site
Sportplatz	Sports ground
Tennisplätze	Tennis courts

5.4 Useful Internet Links

Federal Office of Languages (bundeswehr.de, in German):

<https://www.bundeswehr.de/de/organisation/personal/organisation-/das-bundessprachenamt/bundessprachenamt>

Bundeswehr Command and Staff College:

<https://www.bundeswehr.de/en/organization/further-fmod-departments/bundeswehr-command-and-staff-college>

International General/Admiral Staff Officer Course (bundeswehr.de):

<https://www.bundeswehr.de/en/organization/further-fmod-departments/bundeswehr-command-and-staff-college/national-and-international-staff-officer-training/international-general-admiral-staff-officer-course>

Entering and living in Germany – Federal Foreign Office (auswaertiges-amt.de):

<https://www.auswaertiges-amt.de/en/visa-service>

Standardised Language Profile – Wikipedia (in German):

https://de.wikipedia.org/wiki/Standardisiertes_Leistungsprofil

Public Transport:

Deutsche Bahn – <https://int.bahn.de/en>

Verkehrsverbund Rhein-Sieg transport network – <https://www.vrs.de/en/>

Hamburg Public Transport Association – <https://www.hvv.de/en/en>

Information on German Visa Regulations and Immigration:

<https://www.auswaertiges-amt.de/en/visa-service/-/215870>

EDITORIAL INFORMATION

Published by:
Führungsakademie der Bundeswehr
LGAI
Manteuffelstraße 20
22587 Hamburg
Germany

Pictures: Bundeswehr

E-mail:
FueAkBwLGAI@bundeswehr.org

This is a public relations document of the Federal Ministry of Defence. It is distributed free of charge and is not intended for sale.



BUNDESWEHR